

Bridgelux® SMD 2835 0.5W 3V

Product Data Sheet DS242

Introduction

SMD 2835



Features

- Industry-standard 2835 footprint
- Hot-color targeting ensures that color is within the ANSI bin at the typical application conditions of 85°C
- Enables 3- and 5-step MacAdam ellipse custom binning kits
- RoHS compliant and lead free
- Multiple CCT configurations for a wide range of lighting applications

Benefits

- Lower operating and manufacturing cost
- Ease of design and rapid go-to-market
- Uniform, consistent white light
- Reliable and constant white point
- Compliant with environmental standards
- Design flexibility

Contents

Product Feature Map	2
Product Nomenclature	2
Product Selection Guide	3
Performance at Commonly Used Drive Currents	4
Electrical Characteristics	5
Absolute Maximum Ratings	6
Product Bin Definitions	7
Performance Curves	10
Typical Radiation Pattern	13
Typical Color Spectrum	14
Mechanical Dimensions	15
Reliability	16
Reflow Characteristics	17
Packaging	18
Design Resources	20
Precautions	20
Disclaimers	20
About Bridgelux	21

Product Feature Map

Bridgelux SMD LED products come in industry standard package sizes and follow ANSI binning standards. These LEDs are optimized for cost and performance, helping to ensure highly competitive system lumen per dollar performance while addressing the stringent efficacy and reliability standards required for modern lighting applications.

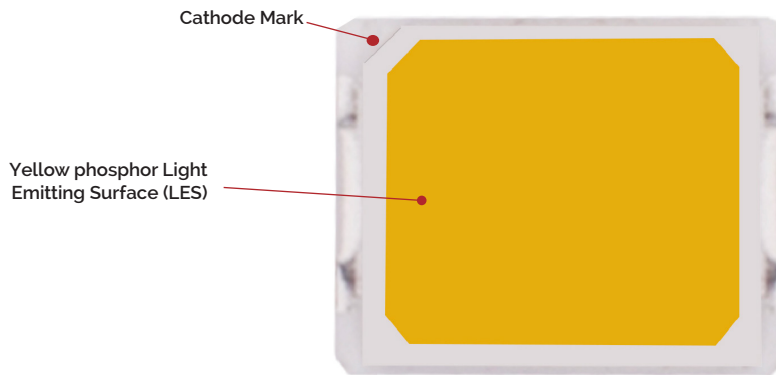

Product Nomenclature

The part number designation for Bridgelux SMD 2835 is explained as follows:

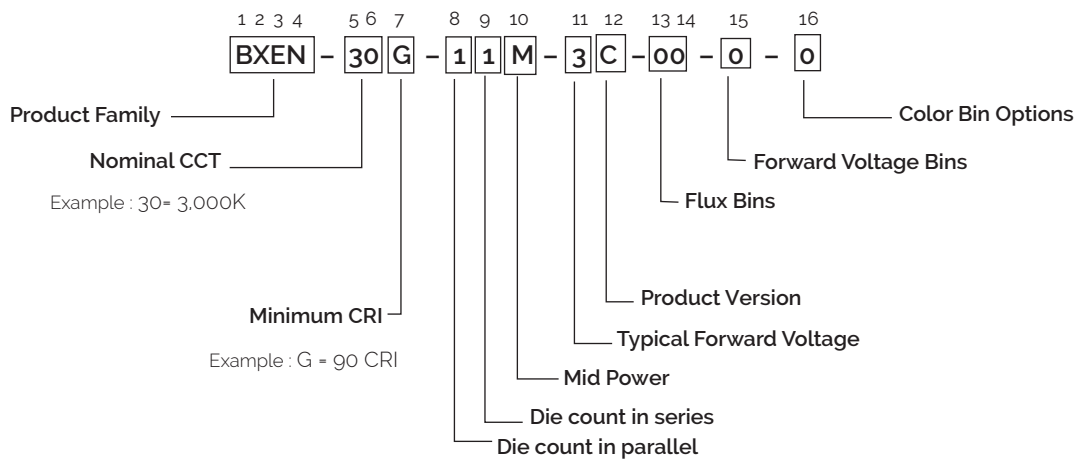

Product Selection Guide

The following product configurations are available:

Table 1: Selection Guide, Pulsed Measurement Data at 150mA ($T_j = T_{sp} = 25^\circ\text{C}$)

Part Number ^{1,6}	Nominal CCT ² (K)	CRI ^{3,5}	Nominal Drive Current (mA)	Forward Voltage ^{4,5} (V)			Typical Pulsed Flux (lm) ^{4,5}	Typical Power (W)	Typical Efficacy (lm/W)
				Min	Typical	Max			
BXEN-18G-11M-3C-00-0-0	1800	90	150	2.8	3.0	3.2	42	0.5	93
BXEN-20G-11M-3C-00-0-0	2000	90	150	2.8	3.0	3.2	50	0.5	111
BXEN-22G-11M-3C-00-0-0	2200	90	150	2.8	3.0	3.2	52	0.5	116
BXEN-25G-11M-3C-00-0-0	2500	90	150	2.8	3.0	3.2	55	0.5	122
BXEN-27G-11M-3C-00-0-0	2700	90	150	2.8	3.0	3.2	58	0.5	129
BXEN-30G-11M-3C-00-0-0	3000	90	150	2.8	3.0	3.2	61	0.5	136
BXEN-35G-11M-3C-00-0-0	3500	90	150	2.8	3.0	3.2	62	0.5	138
BXEN-40G-11M-3C-00-0-0	4000	90	150	2.8	3.0	3.2	65	0.5	144
BXEN-50G-11M-3C-00-0-0	5000	90	150	2.8	3.0	3.2	65	0.5	144
BXEN-57G-11M-3C-00-0-0	5700	90	150	2.8	3.0	3.2	65	0.5	144
BXEN-65G-11M-3C-00-0-0	6500	90	150	2.8	3.0	3.2	65	0.5	144
BXEN-75G-11M-3C-00-0-0	7500	86	150	2.8	3.0	3.2	65	0.5	144

Table 2: Selection Guide, Pulsed Test Performance ($T_{sp} = 85^\circ\text{C}$)

Part Number ^{1,6}	Nominal CCT ² (K)	CRI ^{3,5}	Nominal Drive Current (mA)	Forward Voltage ⁵ (V)			Typical Pulsed Flux (lm) ⁵	Typical Power (W)	Typical Efficacy (lm/W)
				Min	Typical	Max			
BXEN-18G-11M-3C-00-0-0	1800	90	150	2.7	2.9	3.1	38	0.4	87
BXEN-20G-11M-3C-00-0-0	2000	90	150	2.7	2.9	3.1	45	0.4	103
BXEN-22G-11M-3C-00-0-0	2200	90	150	2.7	2.9	3.1	47	0.4	104
BXEN-25G-11M-3C-00-0-0	2500	90	150	2.7	2.9	3.1	49	0.4	113
BXEN-27G-11M-3C-00-0-0	2700	90	150	2.7	2.9	3.1	52	0.4	120
BXEN-30G-11M-3C-00-0-0	3000	90	150	2.7	2.9	3.1	55	0.4	126
BXEN-35G-11M-3C-00-0-0	3500	90	150	2.7	2.9	3.1	56	0.4	128
BXEN-40G-11M-3C-00-0-0	4000	90	150	2.7	2.9	3.1	58	0.4	134
BXEN-50G-11M-3C-00-0-0	5000	90	150	2.7	2.9	3.1	58	0.4	134
BXEN-57G-11M-3C-00-0-0	5700	90	150	2.7	2.9	3.1	58	0.4	134
BXEN-65G-11M-3C-00-0-0	6500	90	150	2.7	2.9	3.1	58	0.4	134
BXEN-75G-11M-3C-00-0-0	7500	86	150	2.7	2.9	3.1	58	0.4	134

Notes for Tables 1 & 2:

- The last 6 characters (including hyphens '-') refer to flux bins, forward voltage bins, and color bin options, respectively. "00-0-0" denotes the full distribution of flux, forward voltage, and color bin.
Example: BXEN-30G-11M-3C-00-0-0 refers to the full distribution of flux, forward voltage, and color within a 3000K 7-step ANSI standard chromaticity region with a minimum of 90CRI, and $T_{sp} = 25^\circ\text{C}$, 75G minimum of 86 CRI .1x1 die configuration, mid power, 3.0V typical forward voltage.
- Product CCT is not targeted at $T_{sp} = 85^\circ\text{C}$. Nominal CCT as defined by ANSI C78.377-2011.
- Listed CRIs are minimum values and include test tolerance.
- Products tested under pulsed condition (10ms pulse width) at nominal drive current.
- Bridgelux maintains a $\pm 7.5\%$ tolerance on luminous flux measurements, $\pm 0.1\text{V}$ tolerance on forward voltage measurements, and ± 2 tolerance on CRI measurements for the SMD 2835.
- Refer to Table 6 and Table 7 for Bridgelux SMD 2835 Luminous Flux Binning and Forward Voltage Binning information.

Performance at Commonly Used Drive Currents

SMD 2835 LEDs are tested to the specifications shown using the nominal drive currents in Table 1. SMD 2835 may also be driven at other drive currents dependent on specific application design requirements. The performance at any drive current can be derived from the current vs. voltage characteristics shown in Figure 2 and the relative luminous flux vs. current characteristics shown in Figure 3. The performance at commonly used drive currents is summarized in Table 3.

Part Number	CRI	Drive Current ¹ (mA)	Typical V _f T _{sp} = 25 C (V)	Typical Power T _{sp} = 25 C (W)	Typical Pulsed Flux ² T _{sp} = 25 C (lm)	Typical Pulsed Flux ² T _{sp} = 85 C (lm)	Typical Efficacy T _{sp} = 25 C (lm/W)
BXEN-18G-11M-3C-00-0-0	90	30	2.69	0.1	9.1	8	113
		42	2.74	0.1	12.6	10	110
		60	2.78	0.2	17.8	15	107
		90	2.86	0.3	26.2	22	102
		120	2.93	0.4	34.2	28	97
		150	3.00	0.5	42.0	38	93
BXEN-20G-11M-3C-00-0-0	90	30	2.69	0.1	10.8	9	134
		42	2.74	0.1	15.0	12	130
		60	2.78	0.2	21.2	18	127
		90	2.86	0.3	31.2	26	121
		120	2.93	0.4	40.7	33	116
		150	3.00	0.5	50.0	45	111
BXEN-22G-11M-3C-00-0-0	90	30	2.69	0.1	11.3	10	140
		42	2.74	0.1	15.7	13	136
		60	2.78	0.2	22.1	18	133
		90	2.86	0.3	32.5	27	126
		120	2.93	0.4	42.3	35	120
		150	3.00	0.5	52.0	47	116
BXEN-25G-11M-3C-00-0-0	90	30	2.69	0.1	12.0	10	148
		42	2.74	0.1	16.6	14	144
		60	2.78	0.2	23.4	19	140
		90	2.86	0.3	34.4	28	134
		120	2.93	0.4	44.7	36	127
		150	3.00	0.5	55.0	49	122
BXEN-27G-11M-3C-00-0-0	90	30	2.69	0.1	12.6	11	156
		42	2.74	0.1	17.5	14	152
		60	2.78	0.2	24.6	21	148
		90	2.86	0.3	36.2	30	141
		120	2.93	0.4	47.2	39	134
		150	3.00	0.5	58.0	52	129
BXEN-30G-11M-3C-00-0-0	90	30	2.69	0.1	13.2	12	164
		42	2.74	0.1	18.4	15	160
		60	2.78	0.2	25.9	22	156
		90	2.86	0.3	38.1	32	148
		120	2.93	0.4	49.7	41	141
		150	3.00	0.5	61.0	55	136
BXEN-35G-11M-3C-00-0-0	90	30	2.69	0.1	13.4	12	166
		42	2.74	0.1	18.7	15	162
		60	2.78	0.2	26.3	22	158
		90	2.86	0.3	38.7	32	150
		120	2.93	0.4	50.5	41	144
		150	3.00	0.5	62.0	56	138
BXEN-40G-11M-3C-00-0-0	90	30	2.69	0.1	14.1	13	174
		42	2.74	0.1	19.6	16	170
		60	2.78	0.2	27.6	23	166
		90	2.86	0.3	40.6	34	158
		120	2.93	0.4	52.9	43	151
		150	3.00	0.5	65.0	58	144
BXEN-50G-11M-3C-00-0-0	90	30	2.69	0.1	14.1	13	174
		42	2.74	0.1	19.6	16	170
		60	2.78	0.2	27.6	23	166
		90	2.86	0.3	40.6	34	158
		120	2.93	0.4	52.9	43	151
		150	3.00	0.5	65.0	58	144
BXEN-57G-11M-3C-00-0-0	90	30	2.69	0.1	14.1	13	174
		42	2.74	0.1	19.6	16	170
		60	2.78	0.2	27.6	23	166
		90	2.86	0.3	40.6	34	158
		120	2.93	0.4	52.9	43	151
		150	3.00	0.5	65.0	58	144
BXEN-65G-11M-3C-00-0-0	90	30	2.69	0.1	14.1	13	174
		42	2.74	0.1	19.6	16	170
		60	2.78	0.2	27.6	23	166
		90	2.86	0.3	40.6	34	158
		120	2.93	0.4	52.9	43	151
		150	3.00	0.5	65.0	58	144
BXEN-75G-11M-3C-00-0-0	86	30	2.69	0.1	14.1	13	174
		42	2.74	0.1	19.6	16	170
		60	2.78	0.2	27.6	23	166
		90	2.86	0.3	40.6	34	158
		120	2.93	0.4	52.9	43	151
		150	3.00	0.5	65.0	58	144

Notes for Table 3:

1. Alternate drive currents in Table 3 are provided for reference only and are not a guarantee of performance.
2. Bridgelux maintains a ± 7.5% tolerance on flux measurements.
3. Typical stabilized pulsed performance values are provided as reference only and are not a guarantee of performance.

Electrical Characteristics

Table 4: Electrical Characteristics

Part Number ¹	Drive Current (mA)	Forward Voltage (V) ^{2,3}			Typical Temperature Coefficient of Forward Voltage $\Delta V_f / \Delta T$ (mV/°C)	Typical Thermal Resistance Junction to Solder Point ³ R_{j-sp} (°C/W)
		Minimum	Typical	Maximum		
BXEN-XXG-11M-3C-00-0-0	150	2.8	3.0	3.2	-1.35	24

Notes for Table 4:

1. Bridgelux maintains a tolerance of $\pm 0.1V$ on forward voltage measurements. Voltage minimum and maximum values at the nominal drive current are guaranteed by 100% test.
2. Products tested under pulsed condition (10ms pulse width) at nominal drive current where $T_{sp} = 25^\circ C$.
3. Thermal resistance value was calculated using total electrical input power; optical power was not subtracted from input power.

Absolute Maximum Ratings

Table 5: Maximum Ratings

Parameter	Maximum Rating
LED Junction Temperature (T_j)	125°C
Storage Temperature	-40°C to +105°C
Operating Solder Point Temperature (T_{sp})	-40°C to +105°C
Soldering Temperature	260°C or lower for a maximum of 10 seconds
Maximum Drive Current	240mA
Maximum Peak Pulsed Forward Current ¹	360mA
Maximum Reverse Voltage ²	-
Moisture Sensitivity Rating	MSL 3
Electrostatic Discharge	2kV HBM. JEDEC-JS-001-HBM and JEDEC-JS-001-2012

Notes for Table 5:

1. Bridgelux recommends a maximum duty cycle of 10% and pulse width of 10 ms when operating LED SMD at maximum peak pulsed current specified. Maximum peak pulsed current indicate values where LED SMD can be driven without catastrophic failures.
2. Light emitting diodes are not designed to be driven in reverse voltage and will not produce light under this condition. no rating is provided.

Product Bin Definitions

Table 6 lists the standard photometric luminous flux bins for Bridgelux SMD 2835 LEDs. Although several bins are listed, product availability in a particular bin varies by production run and by product performance. Not all bins are available in all CCTs.

Table 6: Luminous Flux Bin Definitions at 150mA, $T_{sp}=25^{\circ}\text{C}$

Bin Code	Minimum	Maximum	Unit	Condition
27	35	40	lm	$I_F=150\text{mA}$
28	40	45		
29	45	50		
2A	50	55		
2B	55	60		
2C	60	65		
2D	65	70		
2E	70	75		

Note for Table 6:

1. Bridgelux maintains a tolerance of $\pm 7.5\%$ on luminous flux measurements.

Table 7: Forward Voltage Bin Definition at 150mA, $T_{sp}=25^{\circ}\text{C}$

Bin Code	Minimum	Maximum	Unit	Condition
9	2.7	2.8	V	$I_F=150\text{mA}$
A	2.8	2.9		
B	2.9	3.0		
C	3.0	3.1		
D	3.1	3.2		

Note for Table 7:

1. Bridgelux maintains a tolerance of $\pm 0.1\text{V}$ on forward voltage measurements.

Product Bin Definitions

Table 8: MacAdam Ellipse Color Bin Definitions

CCT	Color Space	Center Point		Major Axis	Minor Axis	Ellipse Rotation Angle	Color Bin
		X	Y				
1800K (T _{sp} =25°C)	5SDCM	0.5496	0.4081	0.0160	0.00765	174	5
2000K (T _{sp} =25°C)	3 SDCM	0.5300	0.4158	0.0096	0.0044	51.67	1
	6 SDCM	0.5300	0.4158	0.0192	0.00882	51.67	1/A/B/C/D
2200K (T _{sp} =25°C)	3 SDCM	0.4958	0.4204	0.00863	0.00398	49.27	1
	5 SDCM	0.4958	0.4204	0.01438	0.00663	49.27	1/A/B/C/D
2500K (T _{sp} =25°C)	3 SDCM	0.4806	0.4141	0.0096	0.0043	53.41	1
	6 SDCM	0.4806	0.4141	0.0192	0.00852	53.41	1/A/B/C/D
2700K	3 SDCM	0.4578	0.4101	0.00810	0.00420	53.70	1
	5 SDCM	0.4578	0.4101	0.01350	0.00700	53.70	1/A/B/C/D
3000K	3 SDCM	0.4338	0.4030	0.00834	0.00408	53.22	1
	5 SDCM	0.4338	0.4030	0.01390	0.00680	53.22	1/A/B/C/D
3500K	3 SDCM	0.4073	0.3917	0.00927	0.00414	54.00	1
	5 SDCM	0.4073	0.3917	0.01545	0.00690	54.00	1/A/B/C/D
4000K	3 SDCM	0.3818	0.3797	0.00939	0.00402	53.72	1
	5 SDCM	0.3818	0.3797	0.01565	0.00670	53.72	1/A/B/C/D
5000K	3 SDCM	0.3447	0.3553	0.00822	0.00354	59.62	1
	5 SDCM	0.3447	0.3553	0.01370	0.00590	59.62	1/A/B/C/D
5700K	3 SDCM	0.3287	0.3417	0.00746	0.00320	59.09	1
	5 SDCM	0.3287	0.3417	0.01243	0.00533	59.09	1/A/B/C/D
6500K	3 SDCM	0.3123	0.3282	0.00669	0.00285	58.57	1
	5 SDCM	0.3123	0.3282	0.01115	0.00475	58.57	1/A/B/C/D
7500K (T _{sp} =25°C)	3 SDCM	0.3000	0.3250	0.00669	0.00285	58.57	1
	5 SDCM	0.3000	0.3250	0.01115	0.00475	58.57	1/A/B/C/D

Point	2200K (T _{sp} =25°C)		2700K		3000K		3500K		4000K		5000K		5700K		6500K		7500K (T _{sp} =25°C)		Color Bin
	x	y	x	y	x	y	x	y	x	y	x	y	x	y	x	y	x	y	
ANSI	0.5193	0.4422	0.4813	0.4319	0.4562	0.4260	0.4299	0.4165	0.4006	0.4044	0.3551	0.3760	0.3376	0.3616	0.3205	0.3481	0.3074	0.3441	E/F/G/H
	0.4942	0.4363	0.4562	0.426	0.4299	0.4165	0.3996	0.4015	0.3736	0.3874	0.3376	0.3616	0.3207	0.3462	0.3028	0.3304	0.2897	0.3264	
	0.4753	0.3996	0.4373	0.3893	0.4147	0.3814	0.3889	0.3690	0.3670	0.3578	0.3366	0.3369	0.3222	0.3243	0.3068	0.3113	0.2937	0.3073	
	0.4973	0.4047	0.4593	0.3944	0.4373	0.3893	0.4147	0.3814	0.3898	0.3716	0.3515	0.3487	0.3366	0.3369	0.3221	0.3261	0.3090	0.3221	
V-up	0.5068	0.4393	0.4687	0.4289	0.4431	0.4213	0.4148	0.4090	0.3871	0.3959	0.3463	0.3687	0.3290	0.3538	0.3115	0.3391	0.2986	0.3353	
	0.5001	0.4272	0.4618	0.4170	0.4377	0.4101	0.4112	0.3996	0.3847	0.3873	0.3457	0.3617	0.3290	0.3470	0.3124	0.3328	0.2994	0.3289	
V-down	0.4863	0.4022	0.4483	0.3919	0.4260	0.3854	0.4018	0.3752	0.3784	0.3647	0.3440	0.3427	0.3290	0.3300	0.3144	0.3186	0.3014	0.3147	
	0.4925	0.4134	0.4542	0.4031	0.4310	0.3960	0.4053	0.3844	0.3807	0.3730	0.3445	0.3495	0.3290	0.3369	0.3135	0.3250	0.3005	0.3210	
H-left	0.4848	0.4180	0.4468	0.4077	0.4223	0.3990	0.3941	0.3848	0.3702	0.3722	0.3371	0.3490	0.3215	0.3350	0.3048	0.3207	0.2917	0.3169	
	0.4905	0.4194	0.4524	0.4089	0.4283	0.4013	0.4012	0.3885	0.3755	0.3755	0.3395	0.3509	0.3240	0.3372	0.3081	0.3240	0.2968	0.3208	
H-right	0.5083	0.4235	0.4703	0.4132	0.4468	0.4077	0.4223	0.3990	0.3950	0.3875	0.3533	0.3620	0.3371	0.3490	0.3213	0.3373	0.3082	0.3331	
	0.5013	0.4219	0.4632	0.4115	0.4394	0.4052	0.4133	0.3945	0.3880	0.3834	0.3498	0.3592	0.3334	0.3456	0.3165	0.3325	0.3042	0.3292	
Center	0.4958	0.4204	0.4578	0.4101	0.4338	0.4030	0.4073	0.3917	0.3818	0.3797	0.3447	0.3553	0.3287	0.3417	0.3123	0.3282	0.3000	0.3250	

Notes for Table 8:

- Color binning at T_{sp}=85°C unless otherwise specified
- Bridgelux maintains a tolerance of ± 0.007 on x and y color coordinates in the CIE 1931 color space.

Product Bin Definitions

Figure 1: C.I.E. 1931 Chromaticity Diagram (9 Color Bin Structure, Hot-color Targeted at $T_{sp}=85^{\circ}\text{C}$, 18G / 20G / 22G / 25G / 75G at $T_{sp}=25^{\circ}\text{C}$)

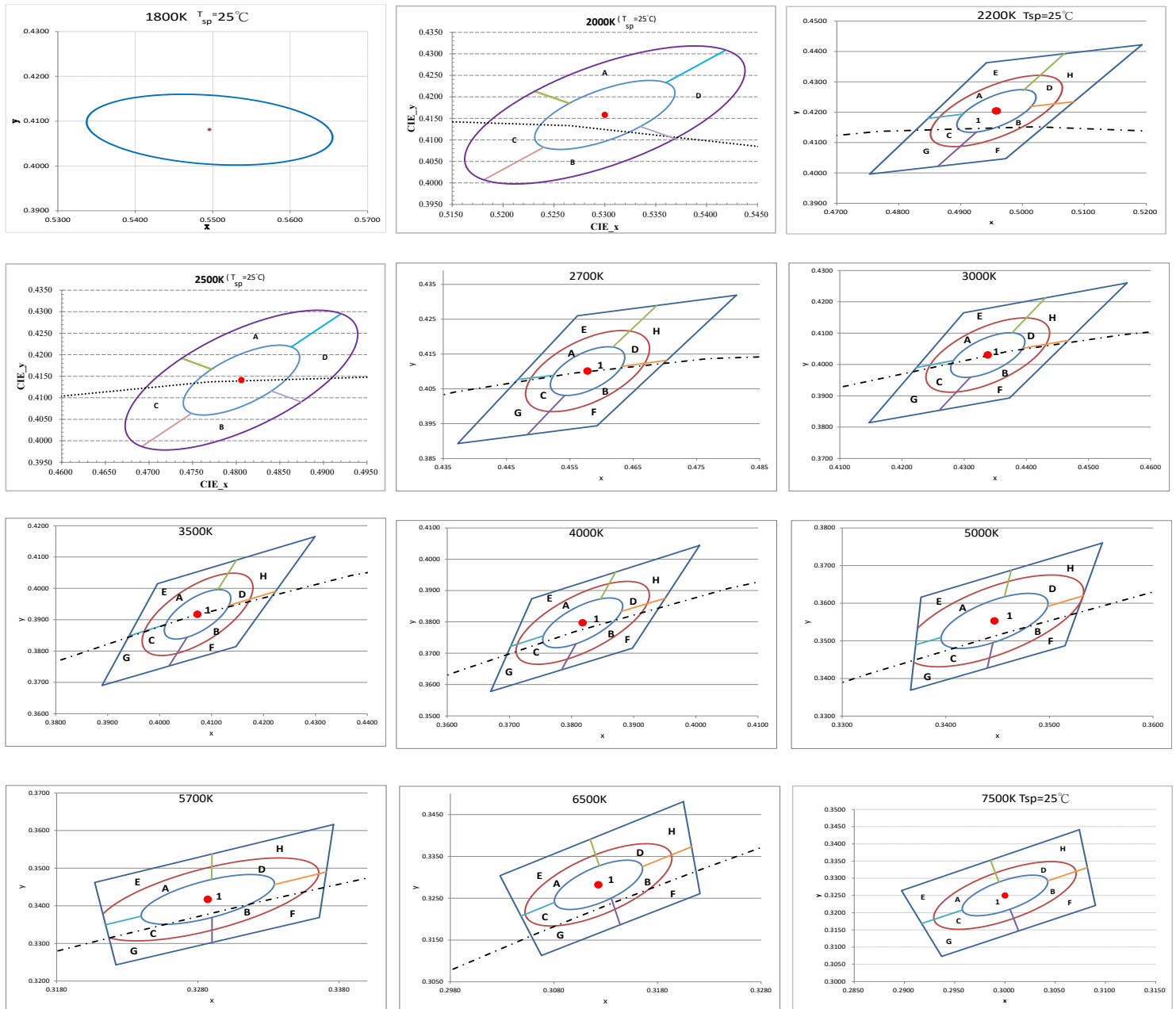

Performance Curves

Figure 2: Drive Current vs. Forward Voltage ($T_{sp}=25^{\circ}\text{C}$)

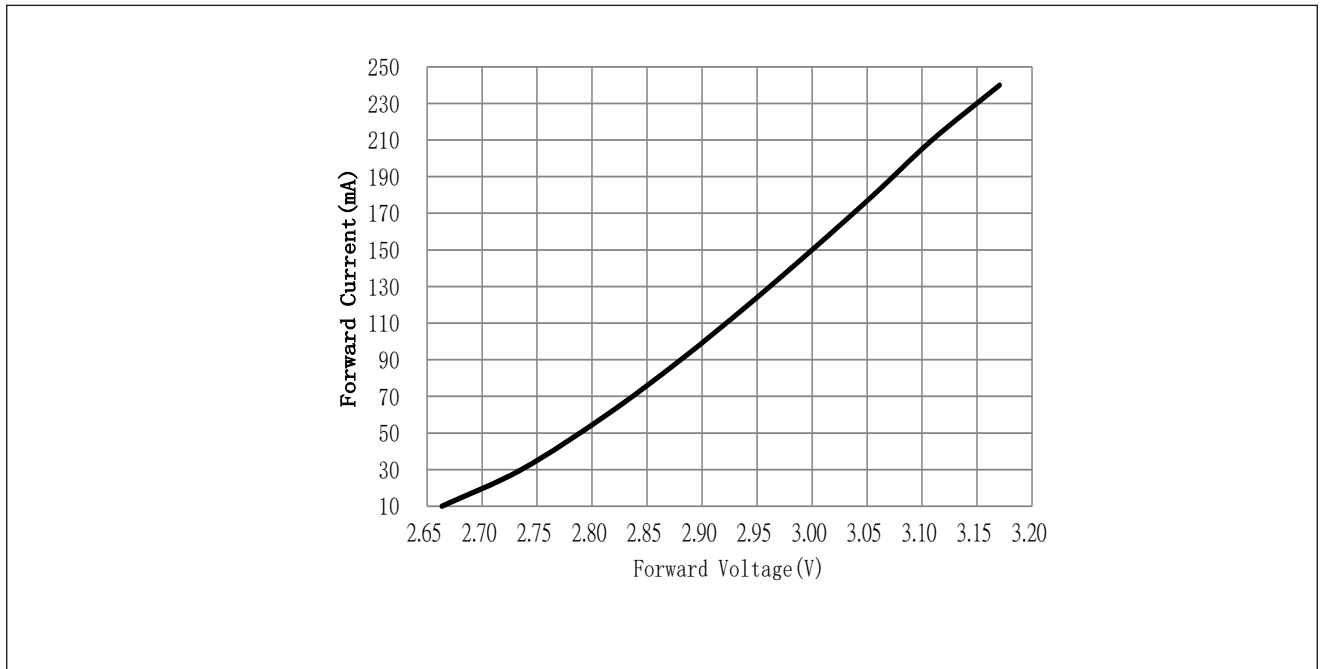
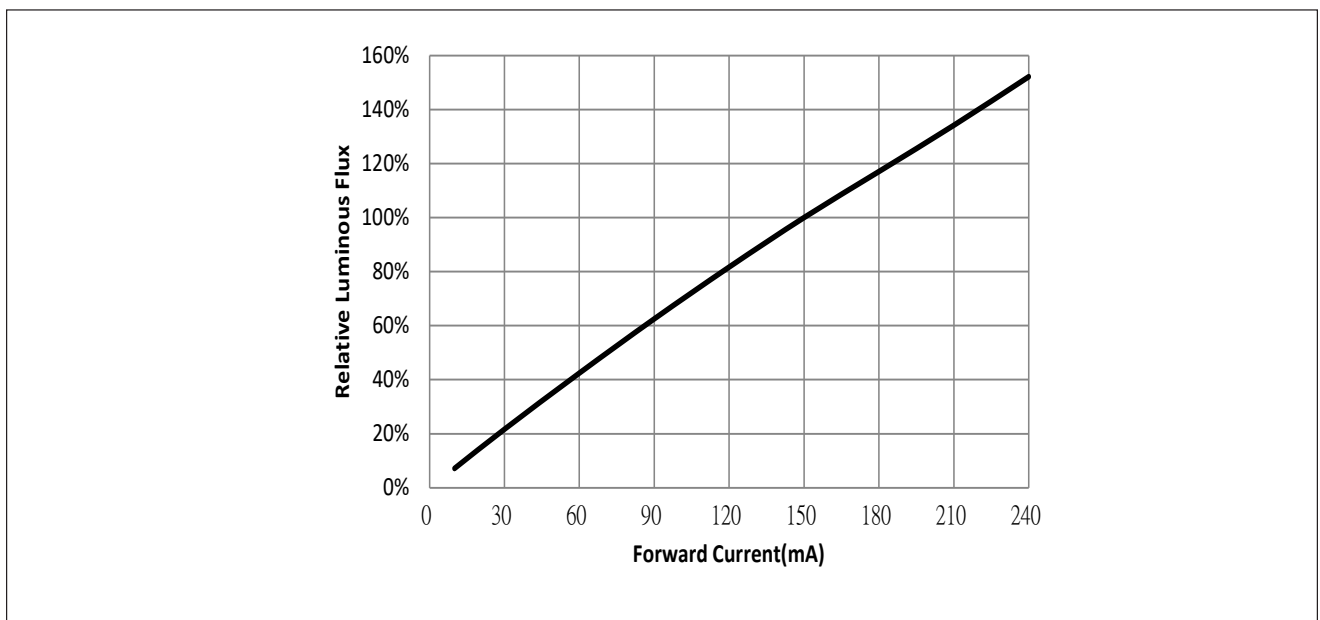

Figure 3: Typical Relative Luminous Flux vs. Forward Current ($T_{sp}=25^{\circ}\text{C}$)



Note for Figure 3:

1. Pulse width modulation (PWM) is recommended for dimming effects.

Performance Curves

Figure 4: Typical Relative Flux vs. Solder Point Temperature

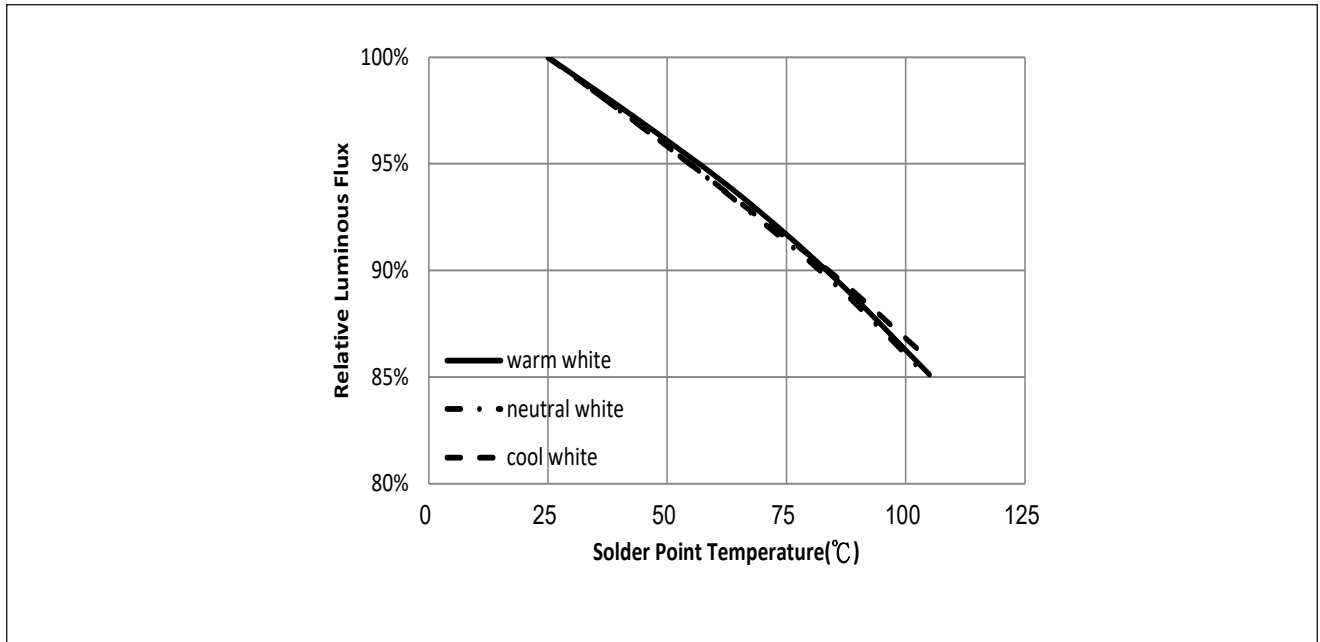
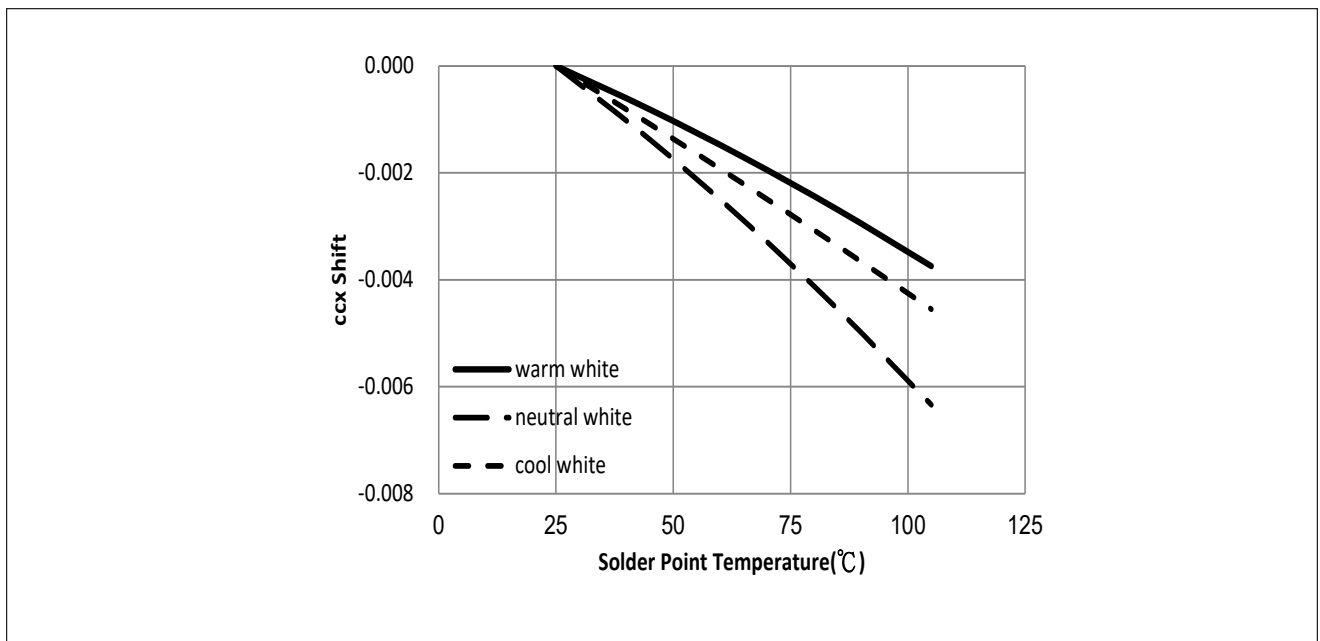

Figure 5: Typical ccx Shift vs. Solder Point Temperature



Notes for Figures 4 & 5:

1. Characteristics shown for warm white based on 3000K and 90 CRI.
2. Characteristics shown for neutral white based on 4000K and 90 CRI.
3. Characteristics shown for cool white based on 5000K and 90 CRI.
4. For other color SKUs, the shift in color will vary. Please contact your Bridgelux Sales Representative for more information.

Performance Curves

Figure 6: Typical ccy Shift vs. Solder Point Temperature

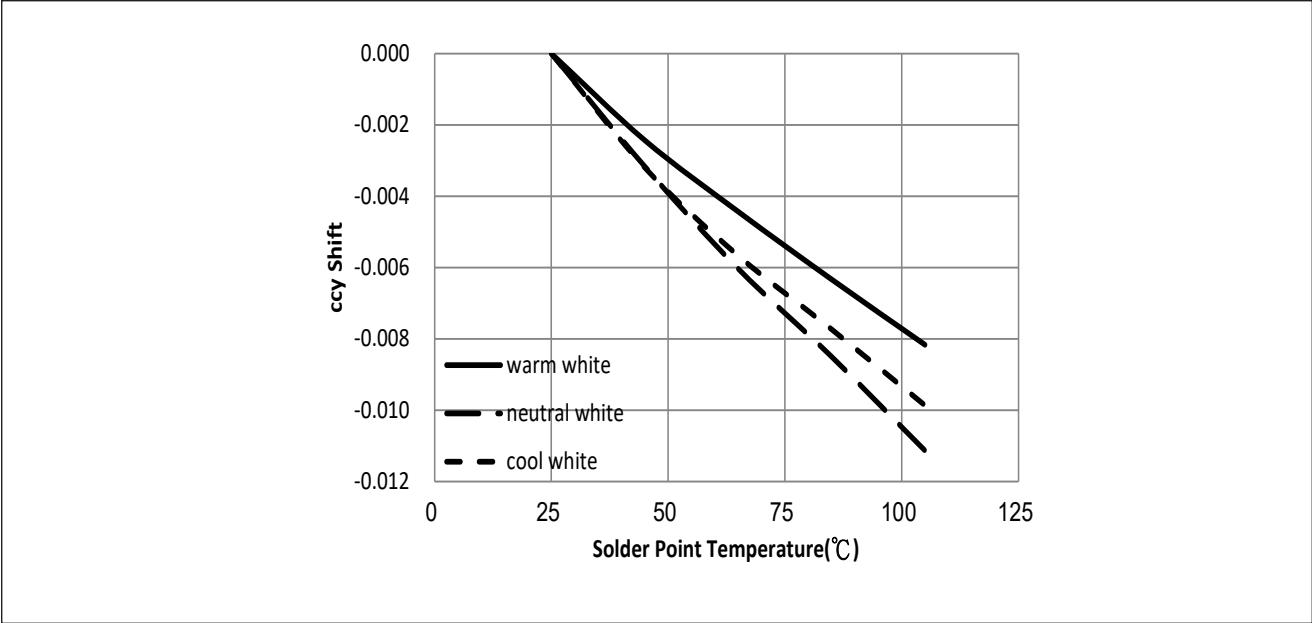

Notes for Figure 6:

- 1. Characteristics shown for warm white based on 3000K and 90 CRI.
- 2. Characteristics shown for neutral white based on 4000K and 90 CRI.
- 3. Characteristics shown for cool white based on 5000K and 90 CRI.
- 4. For other color SKUs, the shift in color will vary. Please contact your Bridgelux Sales Representative for more information.

Typical Radiation Pattern

Figure 7: Typical Spatial Radiation Pattern at 150mA, $T_{sp}=25^{\circ}\text{C}$

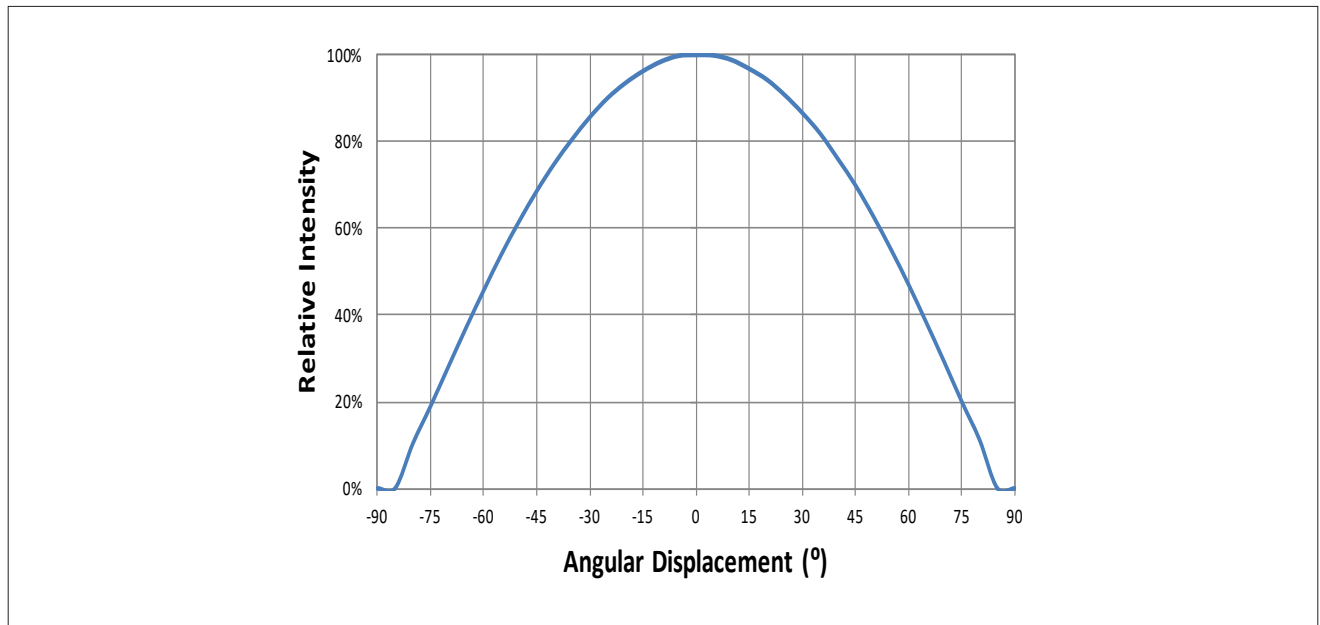

Notes for Figure 7:

1. Typical viewing angle is 120° .
2. The viewing angle is defined as the off axis angle from the centerline where luminous intensity (Iv) is $\frac{1}{2}$ of the peak value.

Figure 8: Typical Polar Radiation Pattern at 150mA, $T_{sp}=25^{\circ}\text{C}$

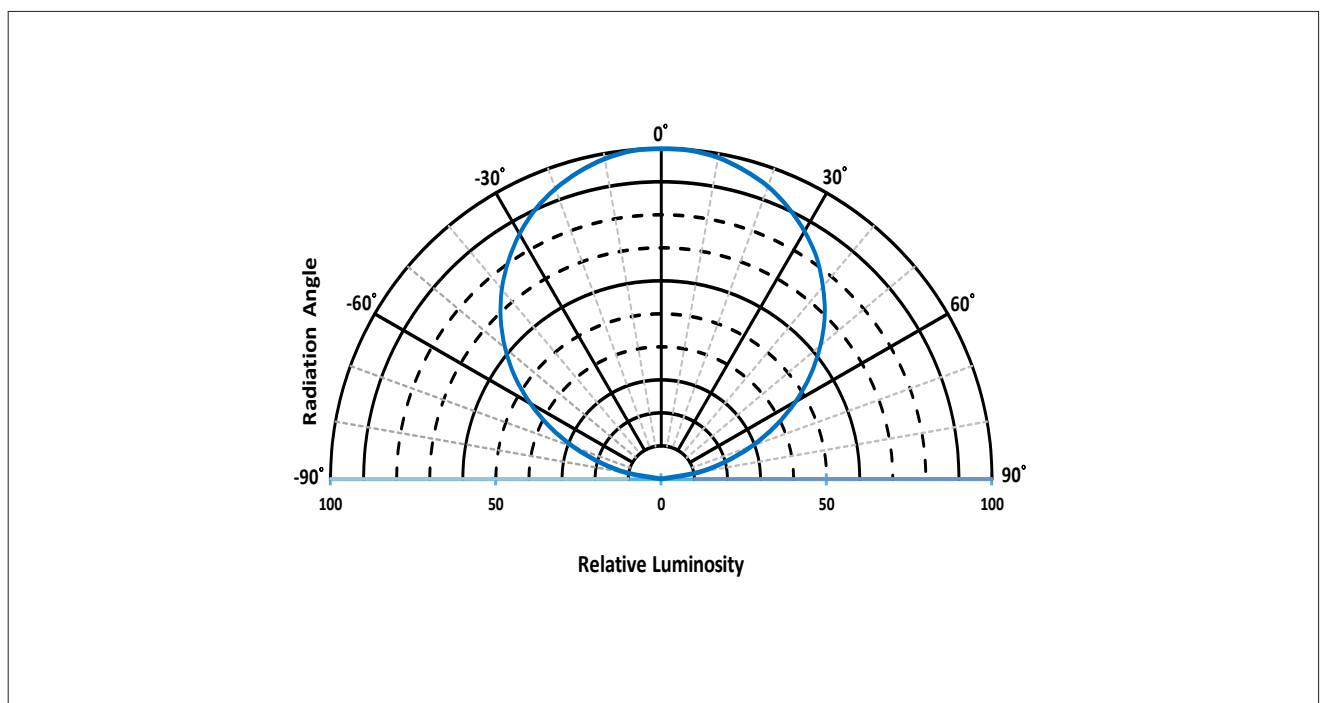

Typical Color Spectrum

Figure 9: Typical Color Spectrum

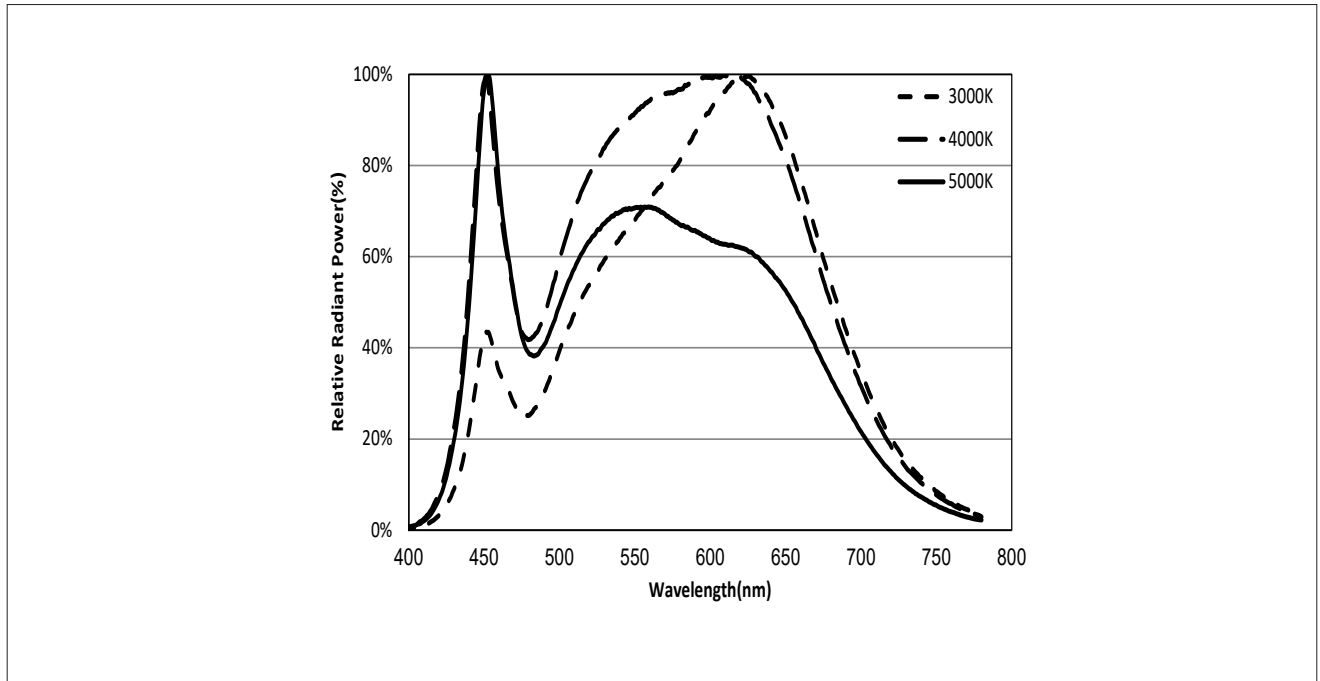

Notes for Figure 9:

1. Color spectra measured at nominal current for $T_{sp} = 25^{\circ}\text{C}$
2. Color spectra shown for 90 CRI products.

Mechanical Dimensions

Figure 10: Drawing for SMD 2835

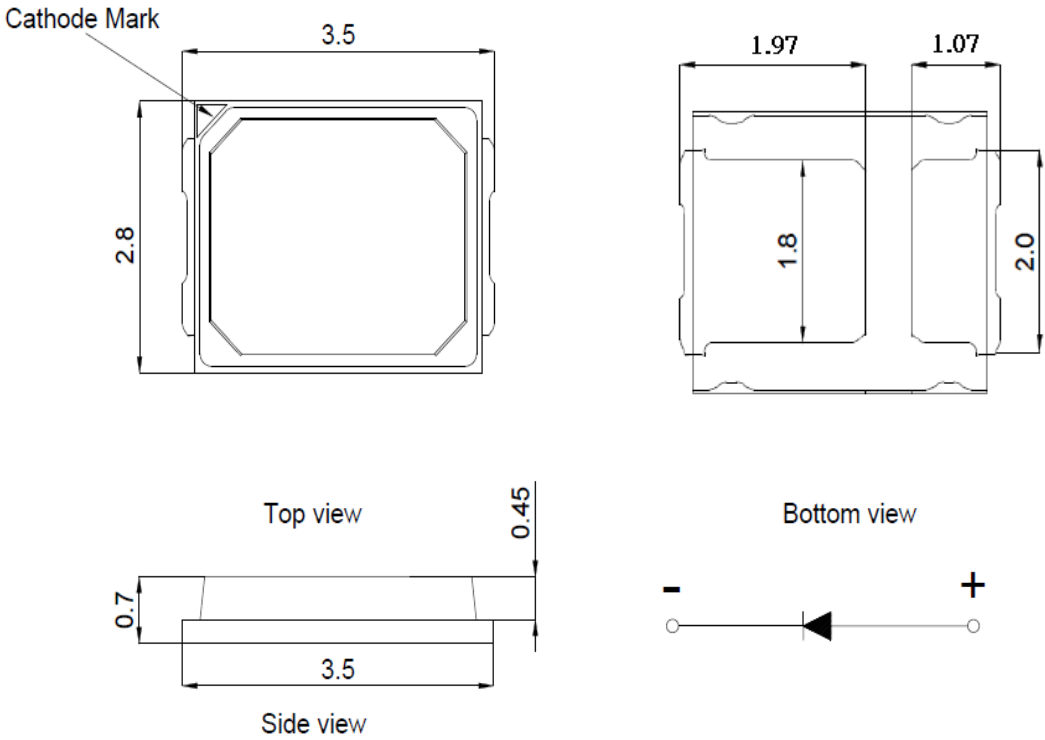

- Notes for Figure 10:
1. Drawings are not to scale.
 2. Drawing dimensions are in millimeters.
 3. Unless otherwise specified, tolerances are $\pm 0.10\text{mm}$.

Recommended PCB Soldering Pad Pattern

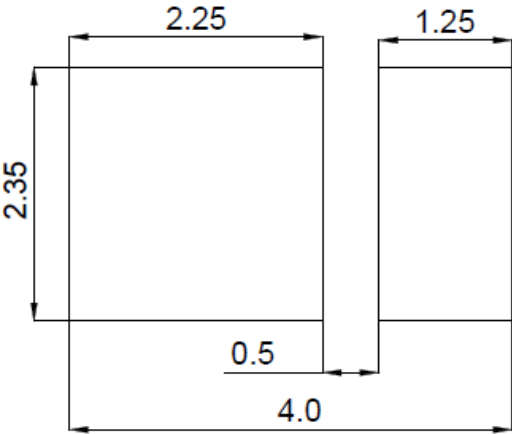

Reliability

Table 9: Reliability Test Items and Conditions

No.	Items	Reference Standard	Test Conditions	Drive Current	Test Duration	Units Failed/Tested
1	Moisture/Reflow Sensitivity	J-STD-020E	$T_{\text{slid}} = 260^{\circ}\text{C}$, 10sec. Precondition: 60°C , 60%RH, 168hr	-	3 reflows	0/20
2	Low Temperature Storage	JESD22-A119	$T_{\text{a}} = -40^{\circ}\text{C}$	-	1000 hours	0/20
3	High Temperature Storage	JESD22-A103D	$T_{\text{a}} = 100^{\circ}\text{C}$	-	1000 hours	0/20
4	Low Temperature Operating Life	JESD22-A108D	$T_{\text{a}} = -40^{\circ}\text{C}$	150mA	1000 hours	0/20
5	Temperature Humidity Operating Life	JESD22-A101C	$T_{\text{sp}} = 85^{\circ}\text{C}$, RH=85%	150mA	1000 hours	0/20
6	High Temperature Operating Life	JESD22-A108D	$T_{\text{sp}} = 85^{\circ}\text{C}$	240mA	1000 hours	0/20
7	Power switching	IEC62717:2014	$T_{\text{sp}} = 85^{\circ}\text{C}$ 30 sec on, 30 sec off	240mA	30000 cycles	0/20

Passing Criteria

Item	Symbol	Test Condition	Passing Criteria
Forward Voltage	Vf	150mA	$\Delta V_f < 10\%$
Luminous Flux	Fv	150mA	$\Delta F_v < 30\%$
Chromaticity Coordinates	(x, y)	150mA	$\Delta u'v' < 0.007$

Notes for Table 9:

- Measurements are performed after allowing the LEDs to return to room temperature
- T_{slid} : reflow soldering temperature; T_{a} : ambient temperature

Reflow Characteristics

Figure 11 : Reflow Profile

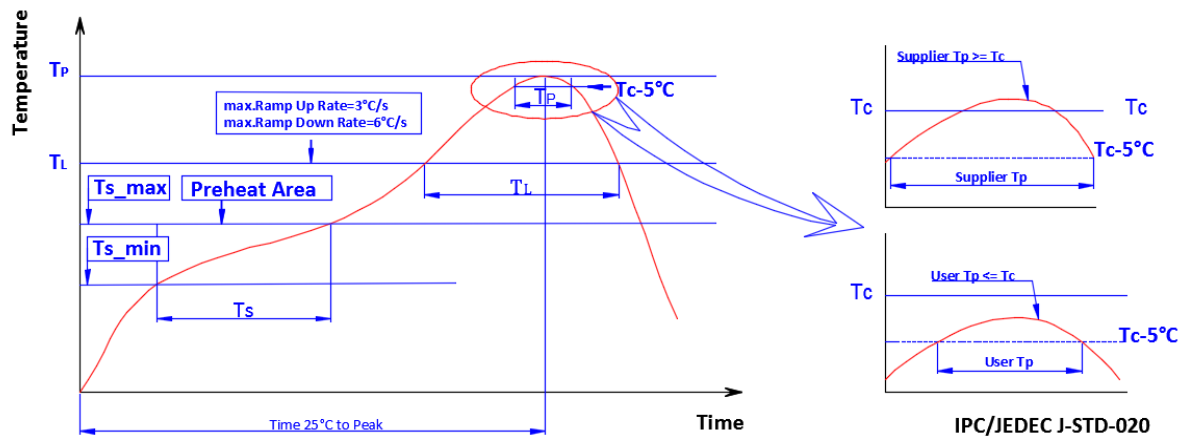

Profile Feature	Lead Free Assembly
Temperature Min. (Ts_min)	160°C
Temperature Max. (Ts_max)	205°C
Time (ts) from Ts_min to Ts_max	60-150 seconds
Ramp-Up Rate (TL to Tp)	3 °C/second
Liquidus Temperature (TL)	220 °C
Time (TL) Maintained Above TL	60-150 seconds
Peak Temp(Tp)	260 °C max.
Time (Tp) Within 5 °C of the Specified Classification Temperature (Tc)	25 seconds max.
Ramp-Down Rate (Tp to TL)	5 °C/second max.
Time 25 °C to Peak Temperature	10 minutes max.

Packaging

Figure 12: Emitter Reel Drawings

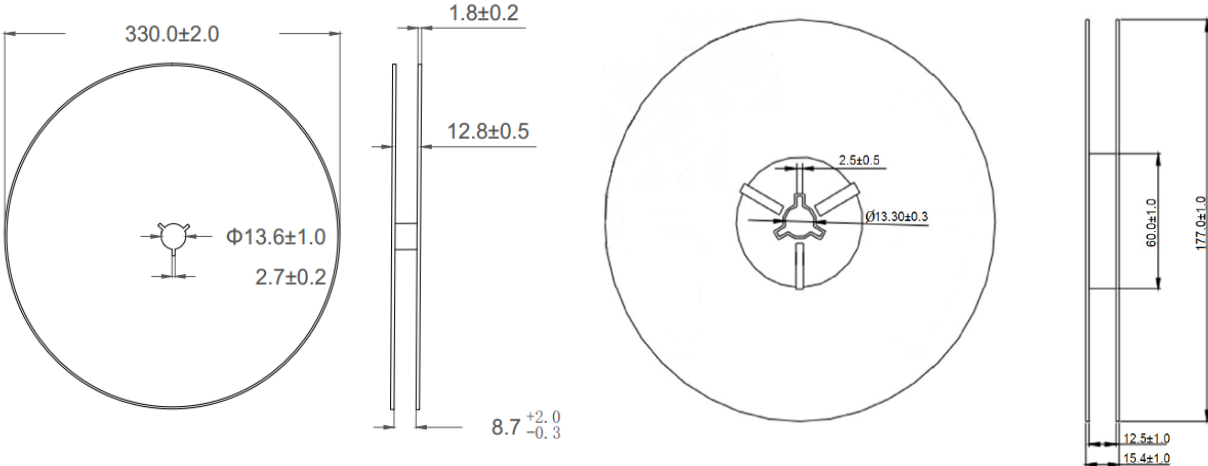

Note for Figure 12:

- 1. Drawings are not to scale. Drawing dimensions are in millimeters.

Figure 13: Emitter Tape Drawings

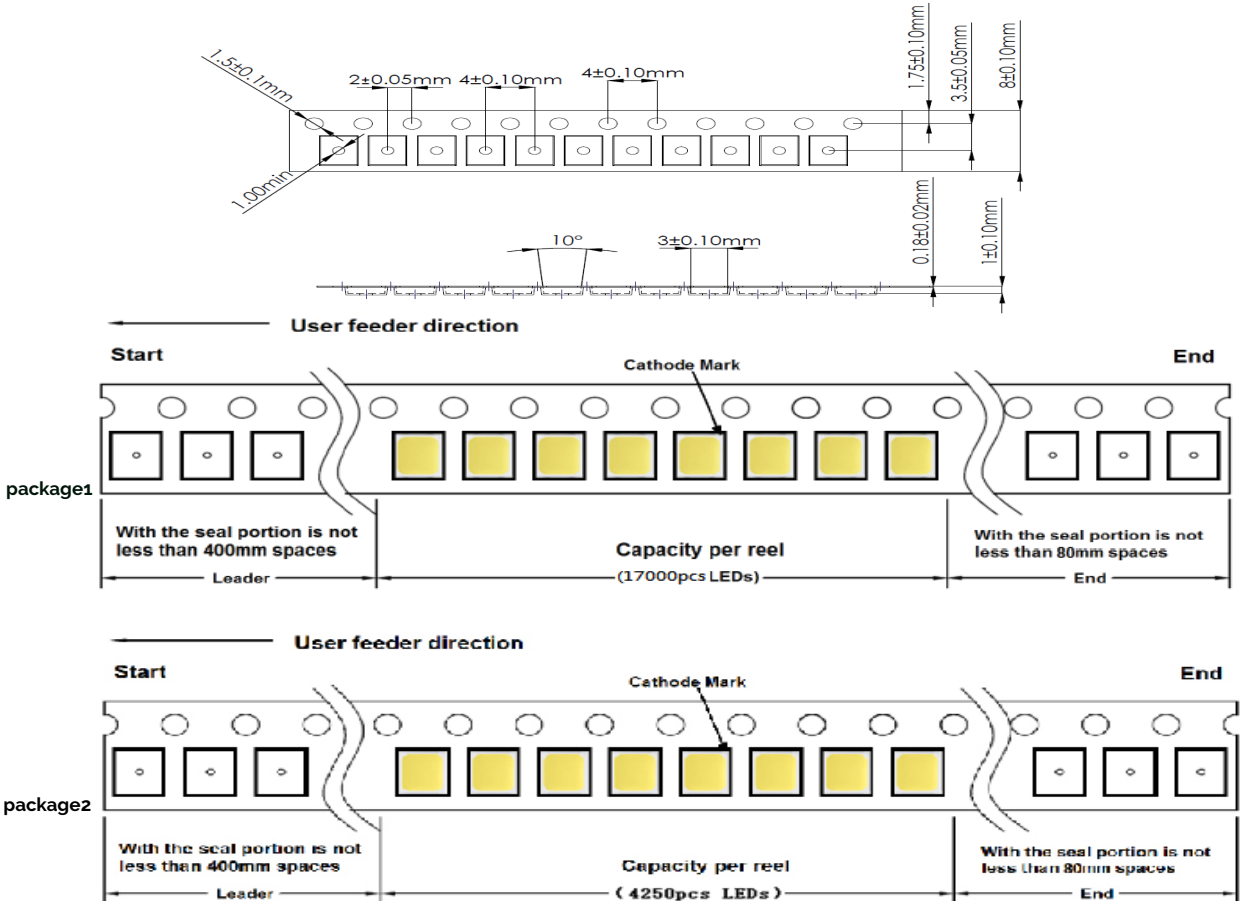

Note for Figure 13:

- 1. Drawings are not to scale. Drawing dimensions are in millimeters.

Packaging

Figure 14: Emitter Reel Packaging Drawings

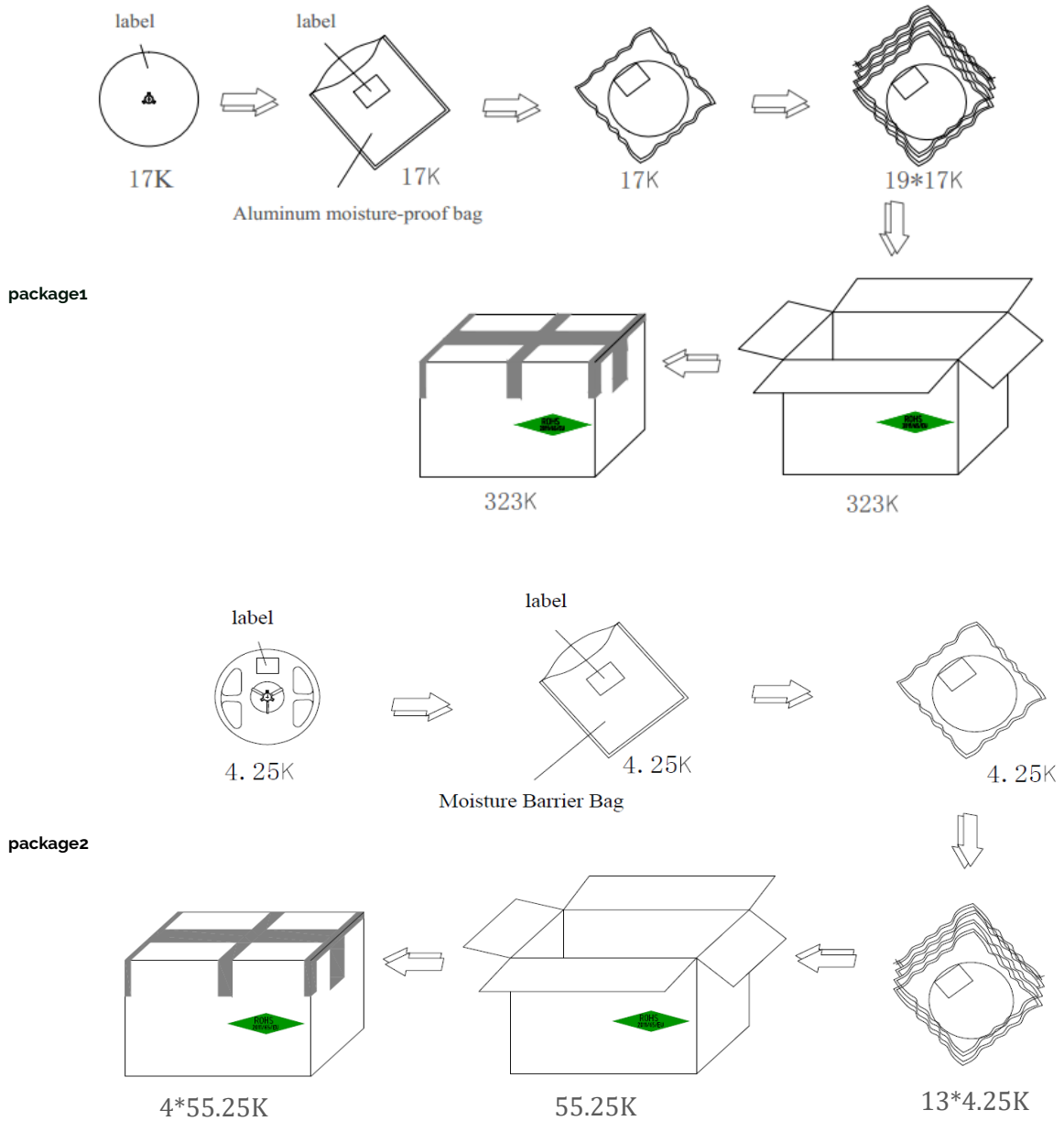

Note for Figure 14:
1. Drawings are not to scale.

Design Resources

Please contact your Bridgelux sales representative for assistance.

Precautions

CAUTION: CHEMICAL EXPOSURE HAZARD

Exposure to some chemicals commonly used in luminaire manufacturing and assembly can cause damage to the LED emitter. Please consult Bridgelux Application Note AN51 for additional information.

CAUTION: EYE SAFETY

Eye safety classification for the use of Bridgelux SMD LED emitter is in accordance with IEC specification EN62471: Photobiological Safety of Lamps and Lamp Systems. SMD LED emitters are classified as Risk Group 1 when operated at or below the maximum drive current. Please use appropriate precautions. It is important that employees working with LEDs are trained to use them safely.

CAUTION: RISK OF BURN

Do not touch the SMD LED emitter during operation. Allow the emitter to cool for a sufficient period of time before handling. The SMD LED emitter may reach elevated temperatures such that could burn skin when touched.

CAUTION

CONTACT WITH LIGHT EMITTING SURFACE (LES)

Avoid any contact with the LES. Do not touch the LES of the emitter or apply stress to the LES (yellow phosphor resin area). Contact may cause damage to the emitter

Optics and reflectors must not be mounted in contact with the LES (yellow phosphor resin area).

Disclaimers

MINOR PRODUCT CHANGE POLICY

The rigorous qualification testing on products offered by Bridgelux provides performance assurance. Slight cosmetic changes that do not affect form, fit, or function may occur as Bridgelux continues product optimization.

STANDARD TEST CONDITIONS

Unless otherwise stated, LED emitter testing is performed at the nominal drive current.

About Bridgelux: Bridging Light and Life™

At Bridgelux, we help companies, industries and people experience the power and possibility of light. Since 2002, we've designed LED solutions that are high performing, energy efficient, cost effective and easy to integrate. Our focus is on light's impact on human behavior, delivering products that create better environments, experiences and returns—both experiential and financial. And our patented technology drives new platforms for commercial and industrial luminaires.

For more information about the company, please visit
bridgelux.com
twitter.com/Bridgelux
facebook.com/Bridgelux
youtube.com/user/Bridgelux
WeChat ID: BridgeluxInChina
https://www.linkedin.com/company/bridgelux-inc-_2



46410 Fremont Boulevard
Fremont, CA 94538 USA
Tel (925) 583-8400
Fax (925) 583-8401
www.bridgelux.com

© 2022 Bridgelux, Inc. All rights reserved 2022. Product specifications are subject to change without notice. Bridgelux and the Bridgelux stylized logo design are registered trademarks of Bridgelux, Inc. All other trademarks are the property of their respective owners.